



6 Homefield Mews Blakeney Road, Beckenham

Beckenham

Guide Price **£250,000**



CHARLES EDEN

YOU'LL NOTICE THE DIFFERENCE

6 Homefield Mews Blakeney Road

Beckenham, Beckenham

Charles Eden are proud to offer this delightful one-bedroom first floor flat, spanning an inviting 635 sq ft. Homefield Mews is a secluded development off Blakeney Road and offers peace and tranquility in what otherwise is a bustling Beckenham.

The flat features a spacious reception room, a thoughtfully designed bedroom and a well appointed bathroom. The property also benefits from having an allocated parking space and access to a communal garden.

Another standout feature of the property is its prime location. Just 0.3 miles from Beckenham Junction BR Station, serving London Victoria and trains to Kent. Additionally, Beckenham High Street, with its array of shops, cafes, and amenities, is also a mere 0.3 miles away, ensuring that everything you need is within easy reach.

This property makes it an excellent opportunity for first-time buyers or those looking to downsize.

Council Tax band: C

Tenure: Leasehold

EPC Energy Efficiency Rating: C

EPC Environmental Impact Rating: D

- SECLUDED DEVELOPMENT
- 1 BED FLAT
- FIRST FLOOR
- ALLOCATED PARKING
- 0.3 MILES TO BECKENHAM BR STATION
- 0.3 MILES TO BECKENHAM HIGH STREET
- COUNCIL TAX C





FIRST FLOOR
635 sq.ft. (59.0 sq.m.) approx.

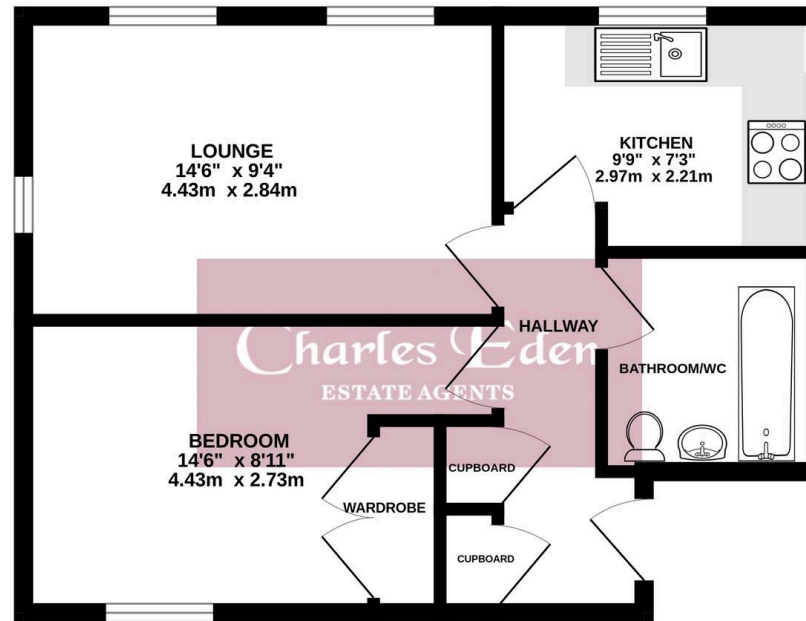

SQUARE FOOTAGE TAKEN FROM EPC

TOTAL FLOOR AREA: 635sq.ft. (59.0 sq.m.) approx.

Whilst every attempt has been made to ensure the accuracy of the floorplan contained here, measurements of doors, windows, rooms and any other items are approximate and no responsibility is taken for any error, omission or mis-statement. This plan is for illustrative purposes only and should be used as such by any prospective purchaser. The services, systems and appliances shown have not been tested and no guarantee as to their operability or efficiency can be given.
Made with Metropix ©2025

Charles Eden

71 High Street, Beckenham – BR3 1AW

02086631964

info@charleseden.co.uk

charleseden.co.uk/

CE

CHARLES EDEN